

Accessories

Ordering code

F-JSI 50 CA

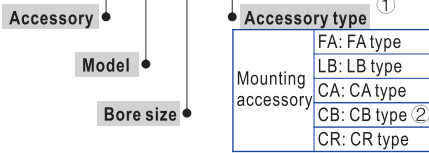

① The listed accessories are for JSI cylinder. Accessories that are adaptable to other cylinders are not shown. Please refer to accessory list on P218 for selection and ordering information.

② CB is attached with relevant PIN.

Accessory selection

Accessories	JSI		JSID		JSIJ		
	Standard	With magnet	Standard	With magnet	Standard	With magnet	
Mounting accessory	LB	●	●	●	●	●	●
	FA	●	●	●	●	●	●
	FB	●	●	×	×	×	×
	CA	●	●	×	×	×	×
	CB	●	●	×	×	×	×
	CR	●	●	×	×	×	×
	TC	●	●	●	●	●	●
	TCM1	●	●	●	●	●	●
	TCM2	●	●	●	●	●	●
	Knuckle ①	I	●	●	●	●	●
Y		●	●	●	●	●	●
U		●	●	●	●	●	●
F		●	●	●	●	●	●
Sensor switch ②	CS1-B	×	●	×	●	×	●
	DS1-B	×	●	×	●	×	●
	CS1-F	×	●	×	●	×	●
	DS1-F	×	●	×	●	×	●
	CS1-U	×	●	×	●	×	●
DS1-U	×	●	×	●	×	●	

① Please refer to P453~456 for knuckle detail.

② Please refer to P457~480 for detail of sensor switch.

Material of accessories

Accessories	Mounting accessories										Knuckle			
	LB	FA	FB	CA	CB	CR	TC	TCM1	TCM2	I	Y	F	U	
32-63	□	●	●	△	△	◇	◇	□	●	□	□	□	□	
80/100	□	●	●	△	△	◇	◇	□	●	□	□	□	□	
125	□	■	■	□	□	◇	◇	□	●	□	□	□	□	

●—Aluminum alloy, ■—Cast steel,
◇—Nodular cast iron, △—FC25; □—Carbon steel.

Dimensions

LB

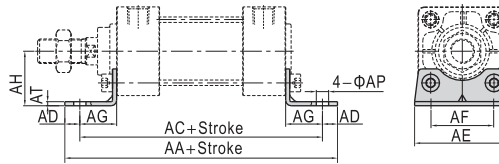

Bore size/Item	AA	AC	AD	AE	AF	AG	AH	AP	AT
32	146	128	9	50	32	22	30	7	3
40	154	132	11	55	38	24	33	9	3
50	170	148	11	70	46	27	40	9	3
63	176	148	14	80	56	27	45	12	4
80	202	174	14	100	72	30	55	12	5
100	210	178	16	120	89	32	65	14	5
125	250	210	20	136	90	45	81	14	8

FA/FB

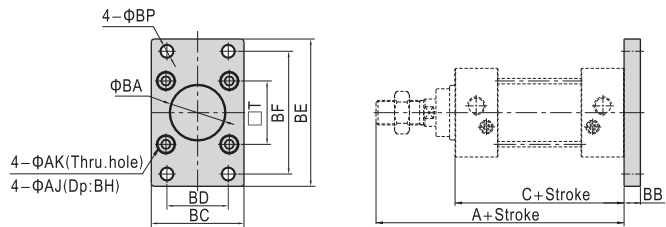
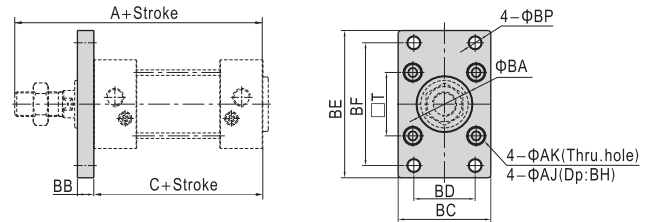

Bore size/Item	A	C	AJ	AK	BA	BB	BC	BD	BE	BF	BH	BP	T
32	131	84	11	6.5	30.5	10	47	32	80	64	6.5	7	32.5
40	135	84	11	6.5	35.5	10	53	36	90	72	6.5	9	38
50	152	94	14	9	40.5	12	65	45	108	90	8.5	9	46.5
63	152	94	14	9	45.5	12	75	50	118	100	8.5	9	56.5
80	186	114	17	11	45.5	16	95	63	150	126	10.5	12.5	72
100	186	114	17	11	55.5	16	115	75	176	150	10.5	14.5	89
125	217	120	19	13	60.5	20	138	102	216	180	12.5	14	110

CA

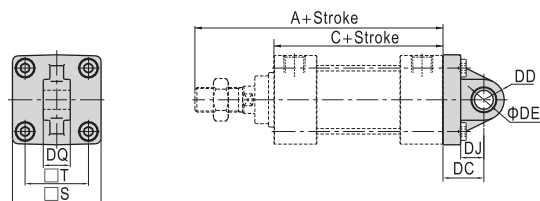

Bore size/Item	A	C	S	T	DC	DD	DE	DJ	DQ
32	131	84	46	32.5	23	10.5	10	13	13.8
40	135	84	52	38	23	11	10	13	13.8
50	152	94	65	46.5	30	15	14	17	19.8
63	152	94	75	56.5	30	15	14	17	19.8
80	186	114	95	72	42	23	22	27	29.8
100	186	114	114	89	42	23	22	27	29.8
125	217	120	136	110	50	28	25	28	31.8



Standard cylinder

Accessories

CB

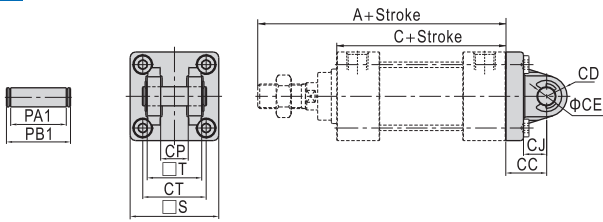

Bore size\Item	A	C	CC	CD	CE	CJ	CP	CT	PA1	PB1	S	T
32	131	84	23	10.5	10	14	14.2	32.5	28.8	34.6	46	28
40	135	84	23	11	10	14	14.2	38	28.8	34.6	52	28
50	152	94	30	15	14	18	20.2	46.5	40.8	47	65	40
63	152	94	30	15	14	18	20.2	56.5	40.8	47	75	40
80	186	114	42	23	22	27	30.2	72	60.8	69.2	95	60
100	186	114	42	23	22	27	30.2	89	60.8	69.2	114	60
125	217	120	50	28	25	32	32.2	110	64.8	73.2	136	64

TC

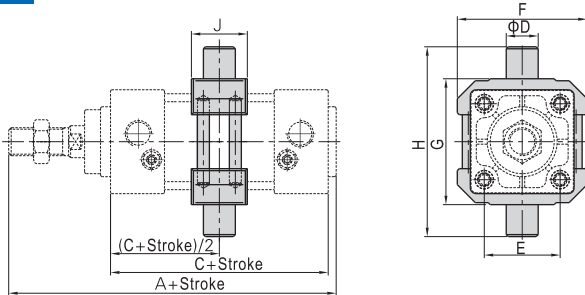

Bore size\Item	A	C	D	E	F	G	H	J
32	135	84	12	32.5	52	50	74	22
40	139	84	16	38	65	63	95	28
50	156	94	16	46.5	75	75	107	28
63	156	94	20	56.5	90	90	130	30
80	190	114	20	72	112	110	150	32
100	190	114	25	89	135	132	182	38
125	223	120	25	110	170	160	210	40

Note) The TC accessory has been installed on the barrel of cylinder before it worked off, and the position of the accessories can not be adjusted arbitrarily.
If consumer orders the TC solely, he will not install it on the barrel of standard cylinder directly.

CR

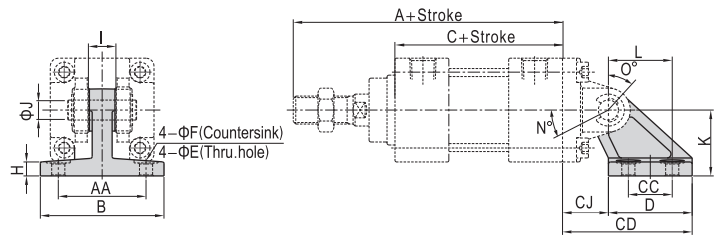

Item Bore size	A	AA	B	C	CC	CD	CJ	D	E	F	H	I	J	K	L	N	O	N+O+90°
32	131	44	62	84	22	65	23	42	6.6	12	7	13.8	10	33	32	25	45	160
40	135	44	62	84	22	65	23	42	6.6	12	7	13.8	10	33	32	25	45	160
50	152	60	81	94	30	84.5	31.5	53	9	15	8	19.8	14	45	43	40	60	190
63	152	60	81	94	30	84.5	31.5	53	9	15	8	19.8	14	45	43	40	60	190
80	186	86	111	114	45	120	47	73	11	18	10	29.8	22	65	64	30	55	175
100	186	86	111	114	45	120	47	73	11	18	10	29.8	22	65	64	30	55	175
125	217	110	136	120	60	143	53	90	13.5	20	14	31.8	25	75	78	30	50	170

Note) CR can't be used alone, it must be used with CB.

TCM1

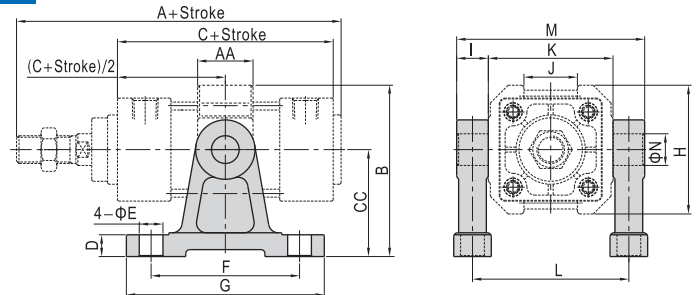

Bore size\Item	A	AA	B	C	CC	D	E	F	G	H	I	J	K	L	M	N
32	135	22	66	84	40	11	9	60	80	52	12	20	50	62	77	12
40	139	28	86.5	84	54	11	12	75	100	65	16	27	63	79	98	16
50	156	28	91.5	94	54	11	12	75	100	75	16	31	75	91	110	16
63	156	30	115	94	70	11	12	85	110	90	20	42	90	110	133	20
80	190	32	126	114	70	11	12	85	110	112	20	54	110	130	153	20
100	190	38	157.5	114	90	19	18	115	155	135	25	68	132	157	185	25
125	223	40	175	120	90	19	18	115	155	170	25	80	160	185	213	25

Note) The installation position of the accessories can not be adjusted arbitrarily.

TCM2

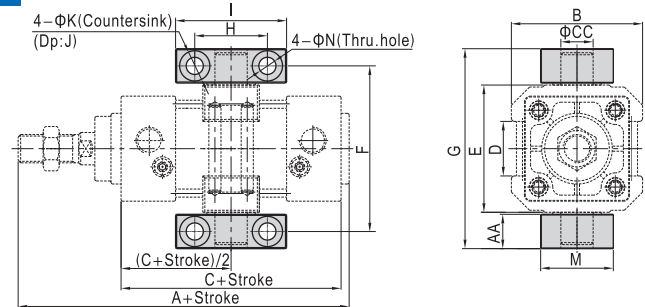

Bore size\Item	A	AA	B	C	CC	D	E	F	G	H	I	J	K	M	N
32	135	14	52	84	12	20	50	66	80	32	46	6.8	11	30	7
40	139	17	65	84	16	27	63	82	99	36	55	9	15	36	9
50	156	17	75	94	16	31	75	94	111	36	55	9	15	36	9
63	156	20.5	90	94	20	42	90	113.5	134	42	65	11	18	40	11
80	190	20.5	112	114	20	54	110	133.5	154	42	65	11	18	40	11
100	190	24.5	135	114	25	68	132	159.5	184	50	75	14	20	50	14
125	223	24.5	170	120	25	80	160	187.5	212	50	75	14	20	50	14

Note) The installation position of the accessories can not be adjusted arbitrarily.

Accessories

Ordering code

F-ACQ 50 LB

Accessory Model Bore size

Accessory type ①

Mounting accessory	LB: LB type FA: FA type FB: FB type CB: CB type ②
Knuckle ③	I: I Knuckle Y: Y Knuckle

- ① Please refer to accessory list for selection and ordering information.
- ② CB is attached with relevant PIN.
- ③ Please refer to page 455, 456 for others knuckle.

Accessory selection

Cylinder model	Accessories	Mounting accessory	Knuckle ①		Sensor switch ②			
			I	Y	CS1-J	CS1-G	DS1-H	
ACQ	Female thread	Standard	●	●	●	●	×	×
	With magnet	●	●	●	●	●	×	●
ATQ	Male thread	Standard	●	●	●	●	×	×
	With magnet	●	●	●	●	●	●	●
ACQD	Female thread	Standard	●	●	×	×	×	×
	With magnet	●	●	×	×	×	●	●
ACQJ	Female thread	Standard	●	●	×	×	×	×
	With magnet	●	●	×	×	×	●	●

- ① Please refer to P453~456 for knuckle detail.
- ② Please refer to P457~480 for detail of sensor switch.
- ③ Mounting accessories and Knuckle unavailable for bore size 125,140,160 cylinder. DS1-H sensor switch only available for bore size 125,140,160 cylinder.

Material of accessories

Bore size	Accessories				Mounting accessories				Knuckle			
	LB	FA	FB	CB	I	Y	F	U				
12、16	△	●	●	●	▲	▲	▲	▲				
20、25	△	●	●	●	▲	▲	▲	▲				
32~100	△	●	●	■	▲	■	▲	▲				

●—Aluminum alloy; ▲—S45C; ■—Cast iron, △—SPCC;

List for ordering code of accessories

Bore size	Accessories			Mounting accessory			Sensor switch
	LB	FA	FB	CB			
12	F-ACQ12LB	F-ACQ12FA	F-ACQ12FB	F-ACQ12CB	CS1-G DS1-G		
16	F-ACQ16LB	F-ACQ16FA	F-ACQ16FB	F-ACQ16CB			
20	F-ACQ20LB	F-ACQ20FA	F-ACQ20FB	F-ACQ20CB			
25	F-ACQ25LB	F-ACQ25FA	F-ACQ25FB	F-ACQ25CB			
32	F-ACQ32LB	F-ACQ32FA	F-ACQ32FB	F-ACQ32CB	CS1-J DS1-J		
40	F-ACQ40LB	F-ACQ40FA	F-ACQ40FB	F-ACQ40CB			
50	F-ACQ50LB	F-ACQ50FA	F-ACQ50FB	F-ACQ50CB			
63	F-ACQ63LB	F-ACQ63FA	F-ACQ63FB	F-ACQ63CB			
80	F-ACQ80LB	F-ACQ80FA	F-ACQ80FB	F-ACQ80CB	CS1-G DS1-G		
100	F-ACQ100LB	F-ACQ100FA	F-ACQ100FB	F-ACQ100CB			
125	-	-	-	-			
140	-	-	-	-			
160	-	-	-	-	DS1-H CS1-G DS1-G		

Bore size	Knuckle			
	I: I Knuckle	Y: Y Knuckle	F: F Knuckle	U: U Knuckle
12	F-ACQ12I	F-ACQ12Y	-	F-M5X080U
16	F-ACQ16I	F-ACQ16Y	-	F-M6X100U
20	F-ACQ20I	F-ACQ20Y	F-M8X125F	F-M8X125U
25	F-ACQ25I	F-ACQ25Y	F-M10X125F	F-M10X125U
32	-	-	-	-
40	F-ACQ32I	F-ACQ32Y	F-M14X150F	F-M14X150U
50	-	-	-	-
63	F-ACQ50I	F-ACQ50Y	F-M18X150F	F-M18X150U
80	F-ACQ80I	F-ACQ80Y	-	-
100	F-ACQ100I	F-ACQ100Y	-	-

Dimensions

FA, FB

Φ12~Φ25

Φ32~Φ100

Item	A			C			M	N	N1	FD	FT	FV	FX	FZ
	Without magnet	With magnet	Stroke	Without magnet	With magnet	Stroke								
12	20.5	-	31.5	17	-	28	15.5	4.5	7.5	4.5	5.5	25	45	55
16	22	22	34	18.5	18.5	30.5	20	4.5	7.5	4.5	5.5	30	45	55
20	24	-	34	19.5	-	29.5	31.5	6.5	10.5	6.5	8	39.5	48	60
25	27.5	-	37.5	22.5	-	32.5	32.5	8	10.5	6.5	8	42	52	64
32	30	-	40	23	-	33	33	8	10.5	5.5	8	48	56	65
40	36.5	-	46.5	29.5	-	39.5	39.5	10	10.5	5.5	8	54	62	72
50	38.5	-	48.5	30.5	-	40.5	40.5	11	13.5	6.5	9	67	76	89
63	44	-	54	36	-	46	46	12	16.5	9	10	80	92	108
80	53.5	-	63.5	43.5	-	53.5	53.5	14	18.5	11	12	99	116	134
100	65	-	75	53	-	63	63	16	18.5	11	12	117	136	154



ACQ



