

0.9° Size 42mm High Torque Hybrid Stepping Motor

● General Specification for High Torque Hybrid Stepping Motor

Item	Specifications
Step Angle	0.9°
Step Angle Accuracy	± 5% (full step, no load)
Resistance Accuracy	± 10%(@20°C)
Inductance Accuracy	± 20%(1kHz)
Temperature Rise	80°C Max.(rated current,2 phase on)
Ambient Temperature	-20°C~+50°C
Insulation Resistance	100MΩ Min. ,500VDC
Dielectric Strength	500VAC for one minute
Shaft Radial Play	0.02Max. (450 g-load)
Shaft Axial Play	0.08Max. (450 g-load)
Max. radial force	28N (20mm from the flange)
Max. axial force	10N



● Size 42mm High Torque Hybrid Stepping Motor Specifications

Model No.		Rated Voltage	Current /Phase	Resistance /Phase	Inductance /Phase	Holding Torque	# of Leads	Rotor Inertia	Weight	Detent Torque	Length
Single Shaft	Double Shaft	V	A	Ω	mH	kg-cm		g-cm ²	kg	g-cm	mm
FL42STH33-0956MA	FL42STH33-0956MB	4	0.95	4.2	4	1.58	6	35	0.22	200	33.5
FL42STH33-0606MA	FL42STH33-0606MB	6	0.6	10	11	1.58	6				
FL42STH33-0316MA	FL42STH33-0316MB	12	0.31	38.5	33	1.58	6				
FL42STH33-1334MA	FL42STH33-1334MB	2.8	1.33	2.1	4.2	2.2	4	54	0.28	220	39.5
FL42STH38-1206MA	FL42STH38-1206MB	4	1.2	3.3	4.1	2.59	6				
FL42STH38-0806MA	FL42STH38-0806MB	6	0.8	7.5	8.3	2.59	6				
FL42STH38-0406MA	FL42STH38-0406MB	12	0.4	30	30	2.59	6				
FL42STH38-1684MA	FL42STH38-1684MB	3.0	1.68	1.8	4.1	3.3	4	68	0.35	250	47.5
FL42STH47-1206MA	FL42STH47-1206MB	4	1.2	3.3	4.9	3.17	6				
FL42STH47-0806MA	FL42STH47-0806MB	6.8	0.8	8.5	10	3.17	6				
FL42STH47-0406MA	FL42STH47-0406MB	12	0.4	30	43	3.17	6				
FL42STH47-1684MA	FL42STH47-1684MB	3.0	1.68	1.8	5.0	4.4	4				

● Dimension

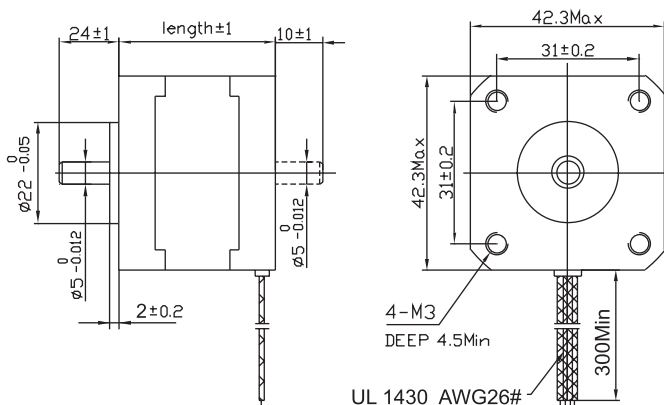

● Wiring Diagram

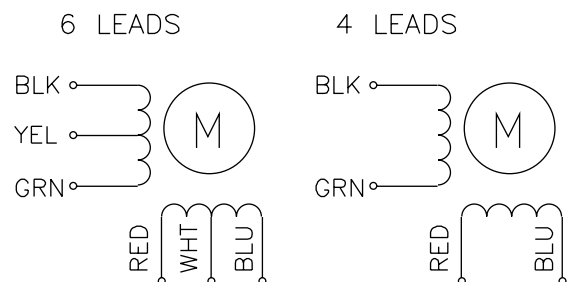



● Pull out Torque Curve

