

# CLAMP FOR INJECTION MOLDING

# TOOLS FOR PROTECTION OF THE TIE-BAR TIE BAR COVER

■ Application It is used for clamping molds with injection molding machine.

■ CLAMP FOR INJECTION MOLDING

M-CE

No.	Part Name	Material	Surface Treatment
①	Body	S45C	Alkaline Blackening
②	Block	SS41	
③	Link	SPCC	
④	Clamping Washer	S45C	

Fittings (8 Pieces per set)  
Hex Bolts / Washers

Bolt Size (8 Pieces)	Dimension	Block Height (mm)	Applicable Mold Thickness (mm)	Reference Tightening Torque (N·m)	Part Number (8 Pieces Set)	Unit Price
	A					1~3 Set
M12×80	95	20×25	20,25,30,35	110	M-CE12-95	Quotation
M16×90					M-CE16-95	
		130	M-CE16-130			

Order **Part Number**  
M-CE12-95  
M-CE16-95  
M-CE16-130

Days to Ship **Quotation**

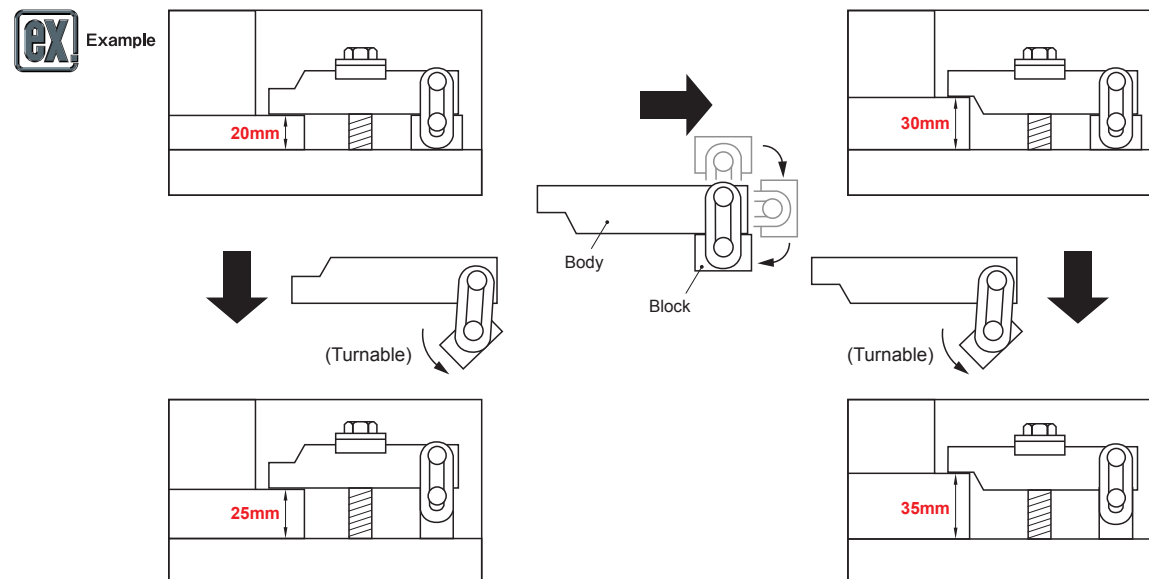

- Features
- Capable of height control in 4 levels. Height control can easily be done by just turning the block.
  - Durable with long life service due to the clamp's fully forged body structure.

■ Application It is used for protecting the tie bar during mold removal and etc.

■ Tie Bar Cover

M-TBR

Material: Nylon

Applied tie bar dia. (φ)	W (mm)	Quantity (pcs)	Part Number		Unit price 1~3 sets
			Type	D	
38~48	26	Yellow 16 Black 16	M-TBR	38	Quotation
50~60				50	
63~73	63				
76~86	76				
89~99	89				
102~124	102				
127~149	127				
152~175	152				

Order **Part Number**  
M-TBR-38

Days to Ship **Quotation**



- How to use
- Protects the tie bar when installing the mold.

CONVEYANCE ASSIST TOOL (GUIDE)  
**SOFT CHUTE GUIDE SKIRT**

**Soft Chute Guide Skirt**

**M-WSMS**

Material ① Body reinforced vinyl  
 • Operating temperature: 93°C or less

Accessories	Quantity	Material
② Shaft	2 pcs	Iron+Chromate plating
③ Mounting stay	4 pcs	Stainless steel
④ Set collar	4 pcs	Iron+unichrome plating
⑤ Bolt (M6×12)	8 pcs	Iron+unichrome plating
⑥ Hexagonal wrench	1 pc	—

W	O	H	L	Part Number		Unit price
				Type	No.	1~3 pcs
300	150	200	610	M-WSMS	1	
460	300	250	760		2	Quotation
560	460	300	860		3	

Order **Part Number** **M-WSMS1** Days to Ship **Quotation**

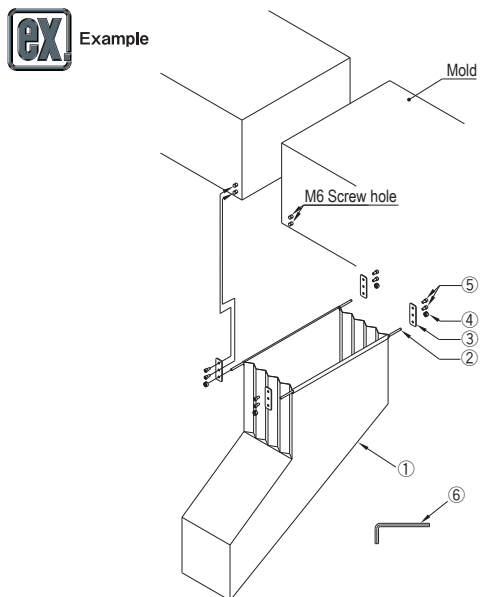

**Soft Chute Guide Skirt Mounting Description**

- 1) Pass the shaft ② through the hole at the top of the soft chute guide skirt ① and attach the mounting stay ③ to the shaft ②.
- 2) To prevent the shaft ② from coming out, insert the set collar ④ and tighten the set screw on the side with the included hex wrench ⑥.
- 3) Tap the mold as an M6 tap, pass the bolts ⑤ through the holes of the mounting stay ③, and fix it to the mold.
- 4) Attach all bolts ⑤. If it is firmly secured with the set collar ④ and does not come off when pulled or pushed by hand, mounting is complete.

CONVEYANCE ASSIST TOOL  
**DROP TRAY**

**Drop Tray**

**M-WDTOOL** (no magnet)  
**M-WDTOOL-MG** (with magnet)

Material: ① Body polypropylene  
 • Operating temperature: 82°C or less

Accessories	Quantity	
	Without Magnet	With Magnet
② Nut	8 pcs	4 pcs
③ Wing nut	4 pcs	4 pcs
④ Eyebolt	8 pcs	4 pcs
⑤ Chain	1.8m	1.8m
⑥ Plate washer	4 pcs	—

• By swapping the left and right, it is possible to prevent the molded item from being dropped by sliding.

D	d	L	l	H	h	Magnet	Part Number	Unit price
								1~3 pcs
435	390	765	566	170	160	No	M-WDTOOL	
						Yes (4 pcs)	M-WDTOOL-MG	Quotation
610	560	970	756	200	180	No	M-WDTOOL2	
						Yes (4 pcs)	M-WDTOOL2-MG	

Order **Part Number** **M-WDTOOL** / **M-WDTOOL-MG** Days to Ship **Quotation**

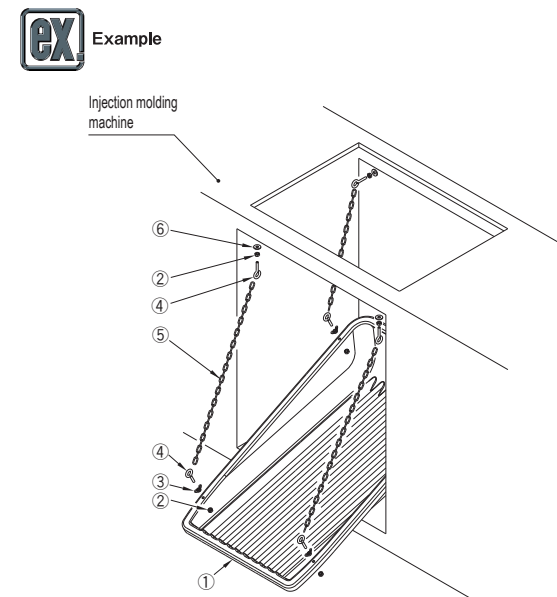

**Drop Tray Mounting Description**

- 1) Attach the eyebolt ④ to the drop tray ① and molding machine. For mounting, refer to the figure on the left. Drill holes into which the M6 bolts are inserted or provide M6 tapping on the molding machine.
  - 2) Attach a chain ⑤ for hanging the drop tray ① from the molding machine. The length of the chain ⑤ is about 1.8 meters. The links can be opened with a tool such as longnose pliers. Depending on the length of the chain ⑤, the inclination of the drop tray ① can be changed. Install it at the length of your choice.
  - 3) After attaching the chain ⑤, hold down the drop tray ① by hand. If it does not tilt or rattle, mounting is complete. (When using magnets) Attach the magnets to the molding machine instead of plate washers ⑥, nuts ② and eye bolts ④.
- Once done, mount in the same procedure as above. If it does not tilt or rattle, mounting is complete.

**M-PSPM** RoHS

● **Photo before assembly**



● **Photo after assembly**



ⓘ This product is delivered exploded. Assemble it before use. (For assembly details, refer to lower right of this page.)

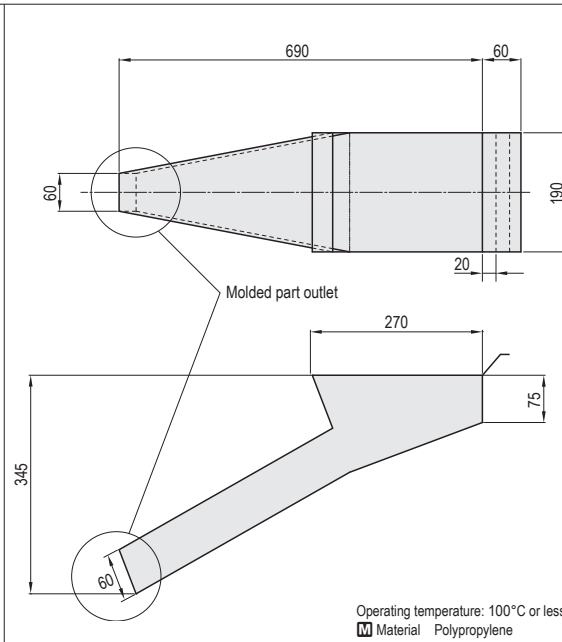

■ **Product Shooter**

- It is a tool for conveying molded products to be taken out by dropping to a container, etc.
- Install it in a space under the molding machine according to the location where the molded product is dropped.

ⓘ Use it for molded products that are smaller than the outlet size of the shooter.

■ **Features**

- Dust does not easily adhere thanks to the antistatic effect of polypropylene.
- As it is made of plastic, it can be wiped off if it gets dirty. If the dirt is severe, it can be wiped off with water and a neutral detergent.

Part Number	Unit price
	1~9 pcs
<b>M-PSPM</b>	<b>Quotation</b>

Order **Part Number**  
**M-PSPM**

Days to Ship **Quotation**

**Quantity Discount Rate**

Order Quantity	Standard Service			Non-Standard Service - Large Quantity
	1-9	10-19	20-29	30-
Quantity	Standard	5%	10%	To be quoted
Rate				

ⓘ Please check with our WOS for the purchase order that exceeds the displayed quantity.

■ **Example**

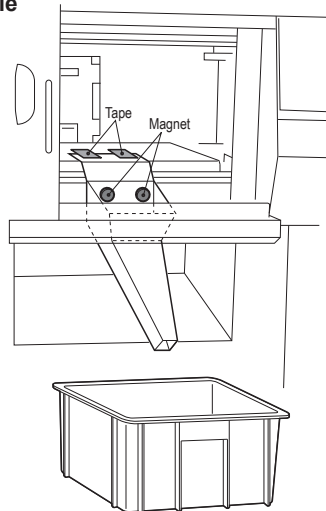

Set it under the molding machine.

■ **How to Assemble**

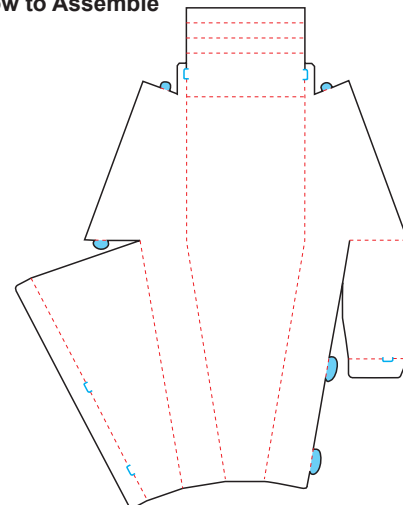

- ① Red dashed lines in the figure above are valley folds.
- ② Insert the blue margin part shown above into the notch indicated by the blue solid line.

■ **Magnet Fixed Type Scatter Guard**



**M-KSD200**

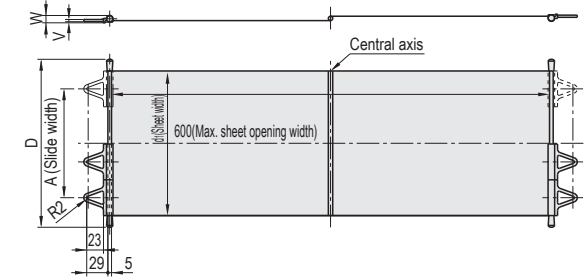

**M-KSD300 M-KSD400 M-KSD500 M-KSD600**

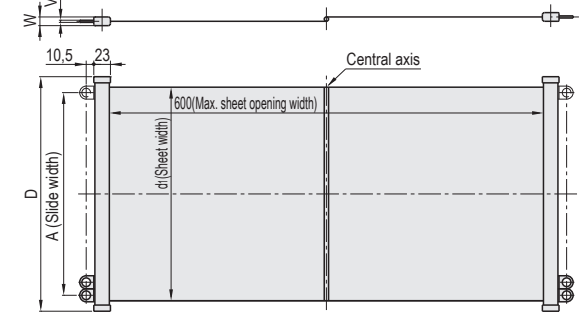

ⓘ M-KSD500 and M-KSD600 have 3 rings on one side for magnet hook.

Material Film: PET

■ **Magnet Fixed Type Scatter Guard**

A	d1	W	V	Part Number		Unit price
				Type	D	1~3 pcs
149	198	10	3	M-KSD	200	Quotation
280	295	12	3		300	
380	395				400	
480	495				500	
580	595				600	

- ⓘ Comes with two films on operation side and reverse operation side
- ⓘ Comes with eight magnets

Order **Part Number**  
**M-KSD-200**  
**M-KSDM8**

Days to Ship **Quotation**

■ **Application**

- Attach four magnets to the molds on both the fixed side and movable side while the operation is stopped before molding.
- Attach the scatter guard to the hook of the magnet to complete installation.

■ **Features**

- Firmly guards the molded parts from scattering.
- The transparent film enables confirmation of the interior.
- It is a type fixed with a magnet, making adjustment, relocation, opening and closing easy.

■ **Magnet (separate)**

Quantity (pcs)	Material	Part Number		Unit price
				1~3 pcs
8	Neodymium	<b>M-KSDM8</b>	<b>Quotation</b>	

# HEAT RETAINING COVER FOR HOPPER DRYER HOSE

■ Application Used to keep the hopper dryer hose warm.

■ Heat retaining cover  
For hopper dryer hose



■ When used



M-DHI



- Inner material: Synthetic refractory fiber (max. 315°C)
- Outer material: Reinforced vinyl
- Lining material: Glass fiber 25 mm (heat insulating material: max. 454°C)
- Fastener: Surface fastener

L (mm)	Applicable Outer diameter of hose (φ)	Part Number		Unit price 1~3 pcs
		Type	D (φ)	
600	35~41	M-DHI	38	Quotation
	47~53		50	
	60~66		63	



Order

Part Number

M-DHI-38



Days to Ship

Quotation

- Depending on the work environment and ambient temperature, heat loss is about 14°C per 300 mm hopper dryer hose can be prevented.
- The applicable hose dimensions can be adjusted by surface fastener (width: 20 mm).

# PNEUMATIC VIBRATION PAD

■ Application Used to shake off powder inside the hopper.

■ Pneumatic Vibration Pad



M-SPA221  
M-SUSPA211

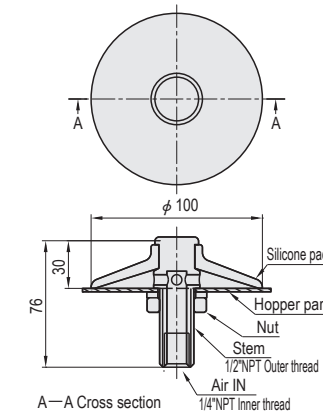

- A silicone disc that does not easily damage the hopper.
- Operating temperature: 170°C or less

Stem material	Color	Part Number	Unit price
			1~3 pcs
Carbon steel	Blue	M-SPA221	Quotation
Stainless steel	White	M-SUSPA211	Quotation



Order

Part Number

M-SPA221  
M-SUSPA211



Days to Ship

Quotation



Example

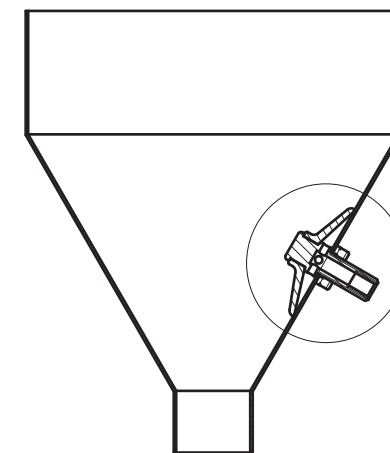

Hopper cross section

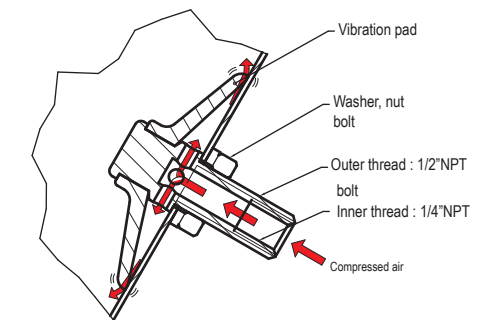

Details of part A

**Caution**  
This product requires drilling on the hopper.  
Be aware of this before use.

## How to use

1. Drill a φ 22 hole on the hopper.  
Attach around the middle of the tapered shape.
2. Remove the washers and nuts that are attached to the main unit, set so that the bolts of the vibration pad protrude from inside the hopper, then attach the washers and nuts.  
(Refer to the figure for the post mounting image.)
3. Install air piping in order to supply compressed air.  
The inner diameter of the vibration pad bolt is 1/4" NPT thread.  
(Since the shape is different from 1/4" PT, we recommend using an NPT → PT conversion plug.)  
Connect the air piping using a plug, coupler, hose joint, etc.
4. Supply air pressure of 0.2 MPa. Since it constantly vibrates and is pressurized while air is being supplied, powder will not enter the vibration pad.  
Even when the air supply is stopped and the vibration stops, the vibration pad and hopper will be in close contact with each other, so there is no ingress of powder.

# PELLET TANK



M-RB

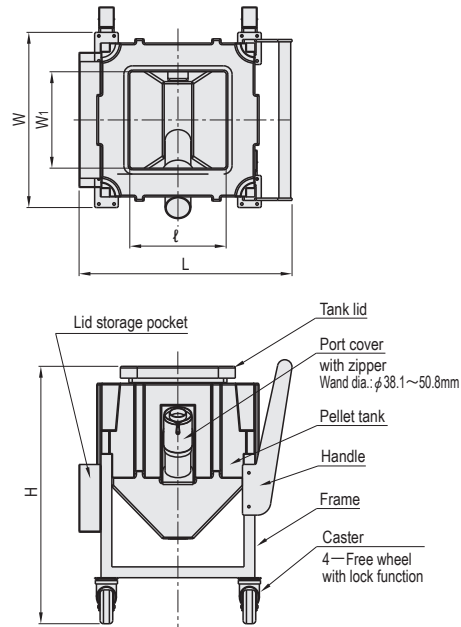

Material Body: HDPE

W	W <sub>1</sub>	L	ℓ	H	Load weight (kg)	Product weight (kg)	Part Number	Unit price
518	285	630	285	760	36	18	M-RB75LX	1~3 pcs
613	380	735	380	970	71	35	M-RB150LX	Quotation

Order **Part Number** M-RB75LX

Days to Ship **Quotation**

- Features**
- It is space-saving as it can be stacked. (Up to 3 levels with empty tank)
  - Casters have locking function.
  - Since the air hopper loader can be inserted fully, it allows extraction with no material residue.

**Function Description**

**[Cover for port]**



• It is a cover with zipper. When a pick up wand is not used, impurities such as dust will not enter if the zipper is closed.

**[Lid storage pocket]**

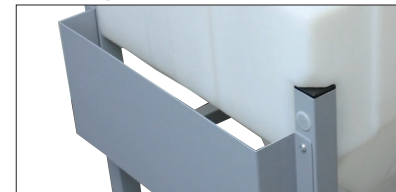

• It is possible to store the lid of the tank.

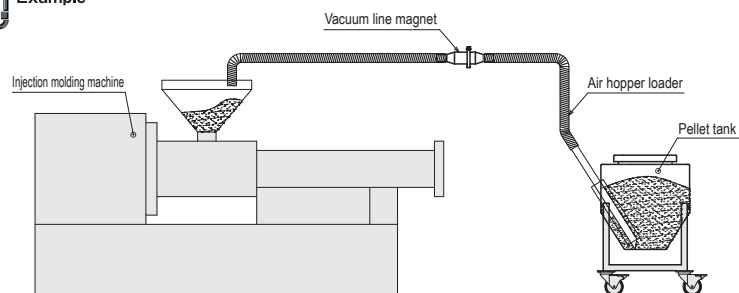

# AIR HOPPER LOADER / PLATEN HOSE CLIP

**Air Hopper Loader**



M-HOPVAC95308

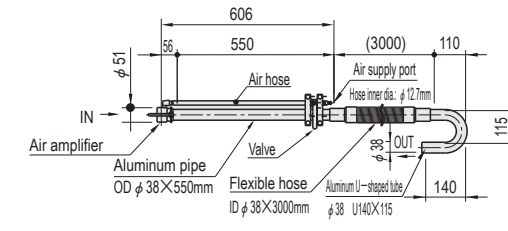

Max. transport volume	22kg/min
Max. flow rate	425L/min
Air pressure	0.55MPa
Inlet inner diameter	φ20.3
Body weight	2600g

Part Number	Unit price
M-HOPVAC95308	1 pc <b>Quotation</b>

**Connection Targets**

- Air amplifier: Material storage such as material tanks (Air amplifier placed at the bottom of the material tank)
- Aluminum U-shaped tube: Hopper for injection molding machine (Hook the U-shaped part on the hopper)

Order **Part Number** M-HOPVAC95308

Days to Ship **Quotation**

**How to use**

- 1 Connect air piping to the air supply port. Air pressure: 0.55 MPa (pressure gauge is not attached to this product).
- 2 Position the air amplifier downward, set it in the material tank, and hook the aluminum U-shaped tube on the opposite side to the hopper.
- 3 Make sure that the material is in the material tank and open the stopper of the ball valve next to the air supply port.
- 4 Material transport will start, and the transporting speed can be adjusted by opening and closing the valve.

**Application** Extends the hose life by preventing wear and bending of the hose. There is a screw size that fits most platens.

**Platen Hose Clip**



M-PHC1

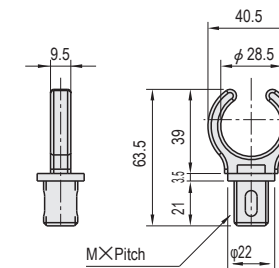

M-PHC2

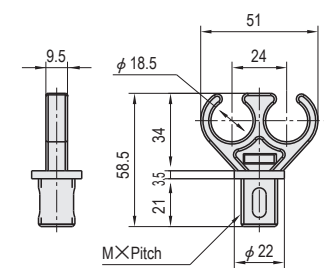

Screw size (M×P)	Applicable external diameter of hose (φ)	Quantity (pcs)	Part Number		Unit price
			Type	No.	
12×1.75 14×2.0 16×2.0 20×2.5	16~29	10	M-PHC1	12	<b>Quotation</b>
				14	
				16	
				20	
12×1.75 14×2.0 16×2.0 20×2.5	9.5~19	10	M-PHC2	12	
				14	
				16	
				20	

Order **Part Number**

Type	No.
M-PHC1	12
M-PHC2	12

Days to Ship **Quotation**